



ShowTime International  
P.O. Box 4200  
Lago Vista, TX 78645  
512-267-7105  
[www.showtimeint.com](http://www.showtimeint.com)

# TEXAS BEST

Langham Creek HS  
17610 FM 529  
Houston, TX 77095

**Registration-** Saturday (usually 8am).

**Schedule-** will be posted online by the Thursday before the contest.

**Performance Area-**Main gym

**Judges Area-**See Diagram

**Team Entrance & Exit-**See Diagram

**Sound Area-**See Diagram

**Floor Surface-**Wooden gym floor

**Dressing Area-**Upstairs, West Wing

**Warm-Up Area-**Commons and auxiliary gym (team and officer), Auditorium(solos)

**Results-** Directors pick up score sheet packets at the awards table after the Awards Ceremony.

Results will be posted on our website one week after the contest.

**Admission-** For current admission prices, please click on the red Admissions button on the right-hand side of the contest page.

**Spectator Parking-**See Diagram 2

**Bus Parking-**See Diagram 2

**Concessions:** No outside food or drink. There will be a concession stand available for the teams and spectators. Please support our hostesses and purchase your meals from their concession stand. They appreciate it!



**[General contest information can be found on our contest page. Click the red buttons on the right side of the contest page.](#)**

# LANCHAM CREEK HS CONTEST AREA



## LCHS 1st Floor Key

-  Green Star – Director & Team Entrance
-  Yellow Triangle – Director & Team Exit
-  Pink Arrow – Director & Team Walking Paths
-  Brown Square – Prop Entrance & Exits
-  Blue Heart – Spectator Entrance & Exits
-  Red Hexagon – No Entry or Exit for Teams
-  Orange Arrow – Vendors & Merchandise Lane
-  Purple Bolt – First Aid & Trainers

- ❖ **Auxiliary Gym** – Team Practice Gym
- ❖ **Performance Gym** – Team & Officer Performance Gym
- ❖ **Multipurpose/Lego Gym** – Prop Storage
- ❖ **Commons** – Concessions & 2<sup>nd</sup> Practice Area (Team or Solo/Ensemble)
- ❖ **Black Box** – Solo & Ensemble Practice Area
- ❖ **Auditorium** – Solo & Ensemble Performance Area
- ❖ **East Side of Campus** – Closed to General Public



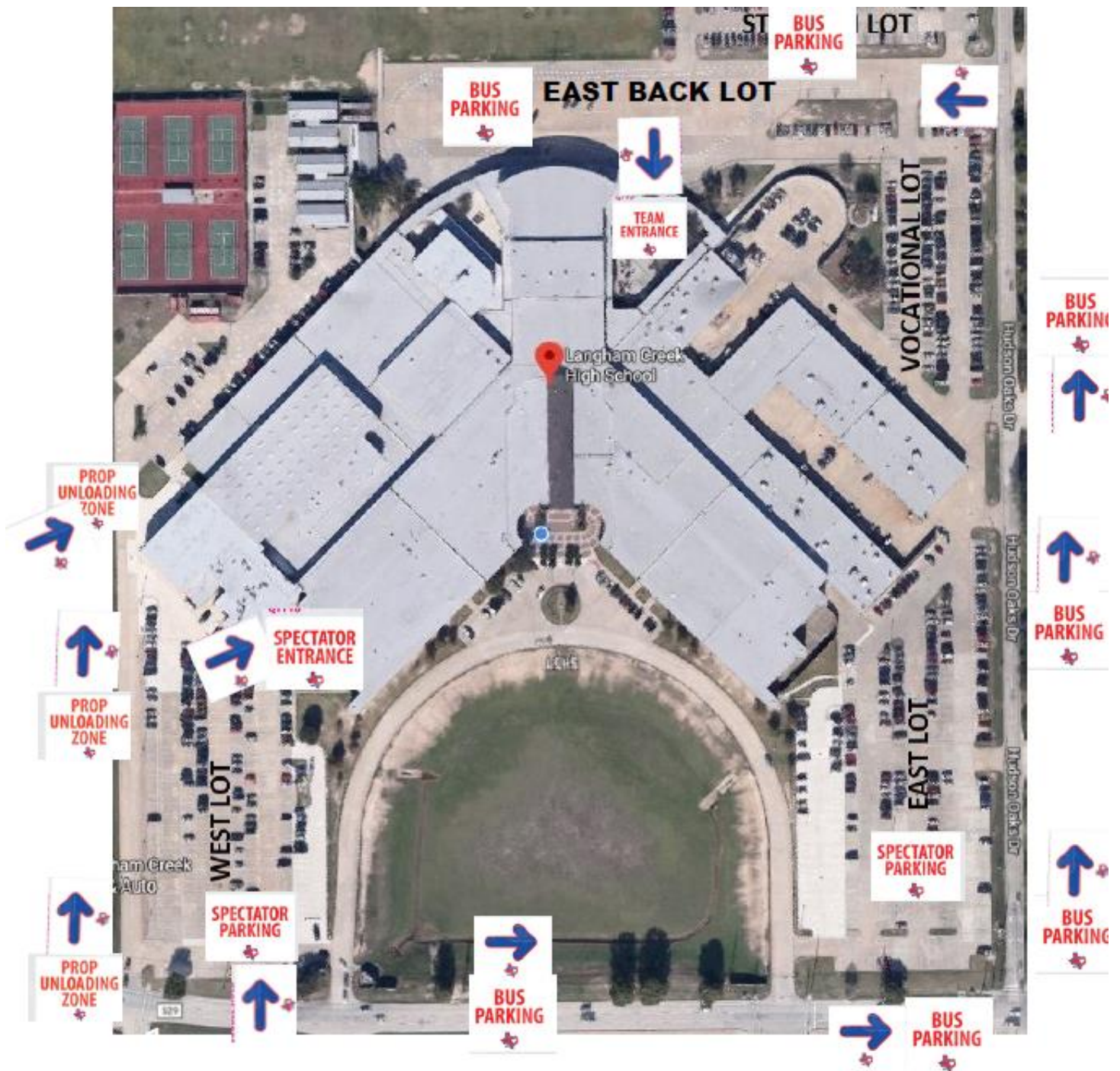

**\*\*\*WEST LOT\*\*\***

**(OFF OF FM 529)**

**PROP UNLOADING  
AT DOOR 13 ONLY**

**SPECTATOR  
ENTRANCE  
AT DOOR 9 ONLY**

**\*\*\*EAST BACK LOT\*\*\***

**(OFF OF HUDSON OAKS DR)**

**DOOR 28 ONLY**

**TEAM ENTRANCE  
VOLUNTEER ENTRANCE  
BUS PARKING**

**\*\*\*NO SPECTATOR ENTRY  
AT DOOR 28!\*\*\***

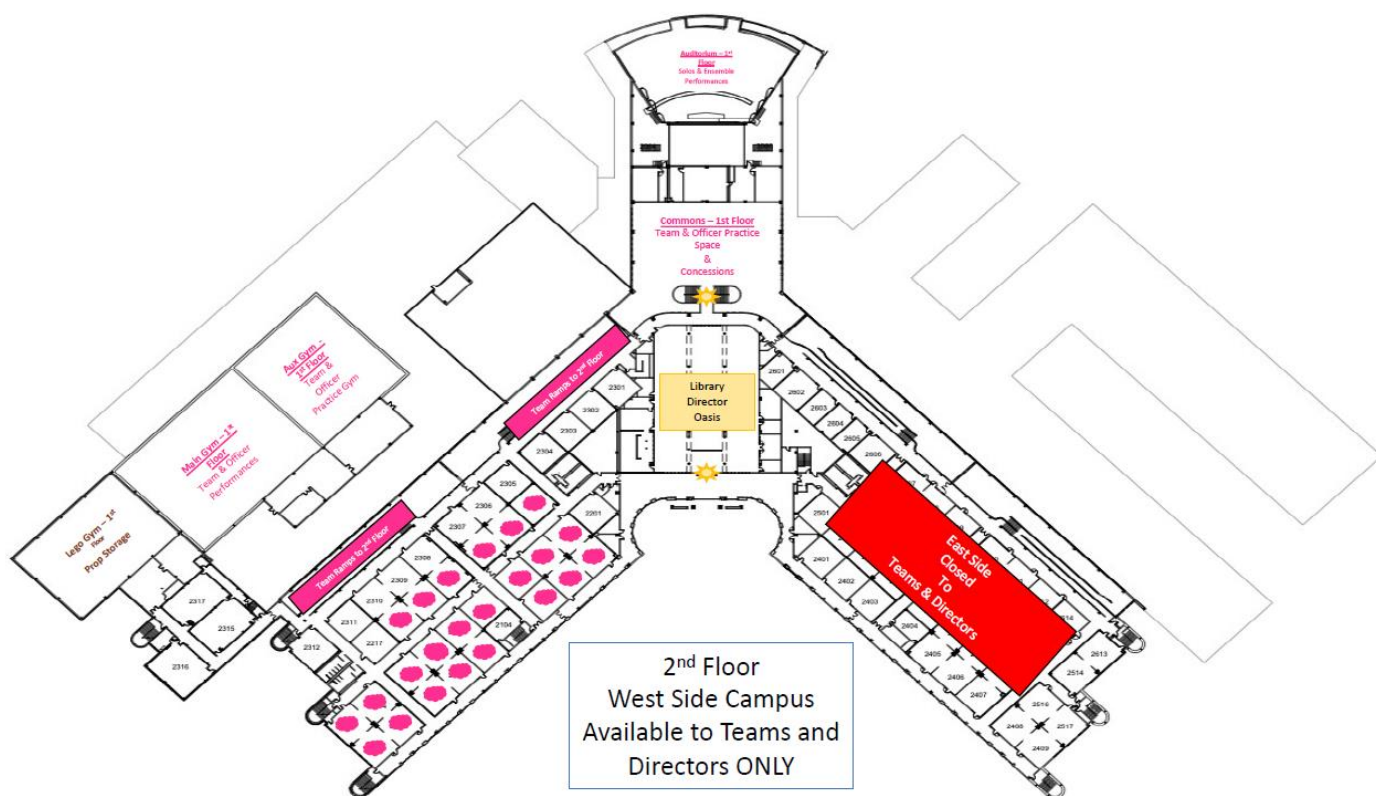

## LCHS 2nd Floor Key



Pink Cloud – Director & Team Dressing Rooms



Yellow Sun – Director Oasis Entry & Director Viewing Spot into Commons

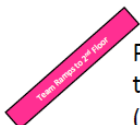

Pink Rectangle – Director & Team Ramps/Stairs to 2<sup>nd</sup> Floor  
(NO MALE SPECTATORS BEYOND THIS POINT)

- ❖ **Auxiliary Gym** – Team Practice Gym
- ❖ **Performance Gym** – Team & Officer Performance Gym
- ❖ **Multipurpose/Lego Gym** – Prop Storage
- ❖ **Commons** – Concessions & 2<sup>nd</sup> Practice Area (Team or Solo/Ensemble)
- ❖ **Black Box** – Solo & Ensemble Practice Area
- ❖ **Auditorium** – Solo & Ensemble Performance Area
- ❖ **Library** – Director Oasis
- ❖ **East Side of Campus** – Closed to General Public